



Raxit Door Seal Exterior Double Door Mounting Guide



Estimated Mounting time for an experienced fitter: 35 minutes

Materials

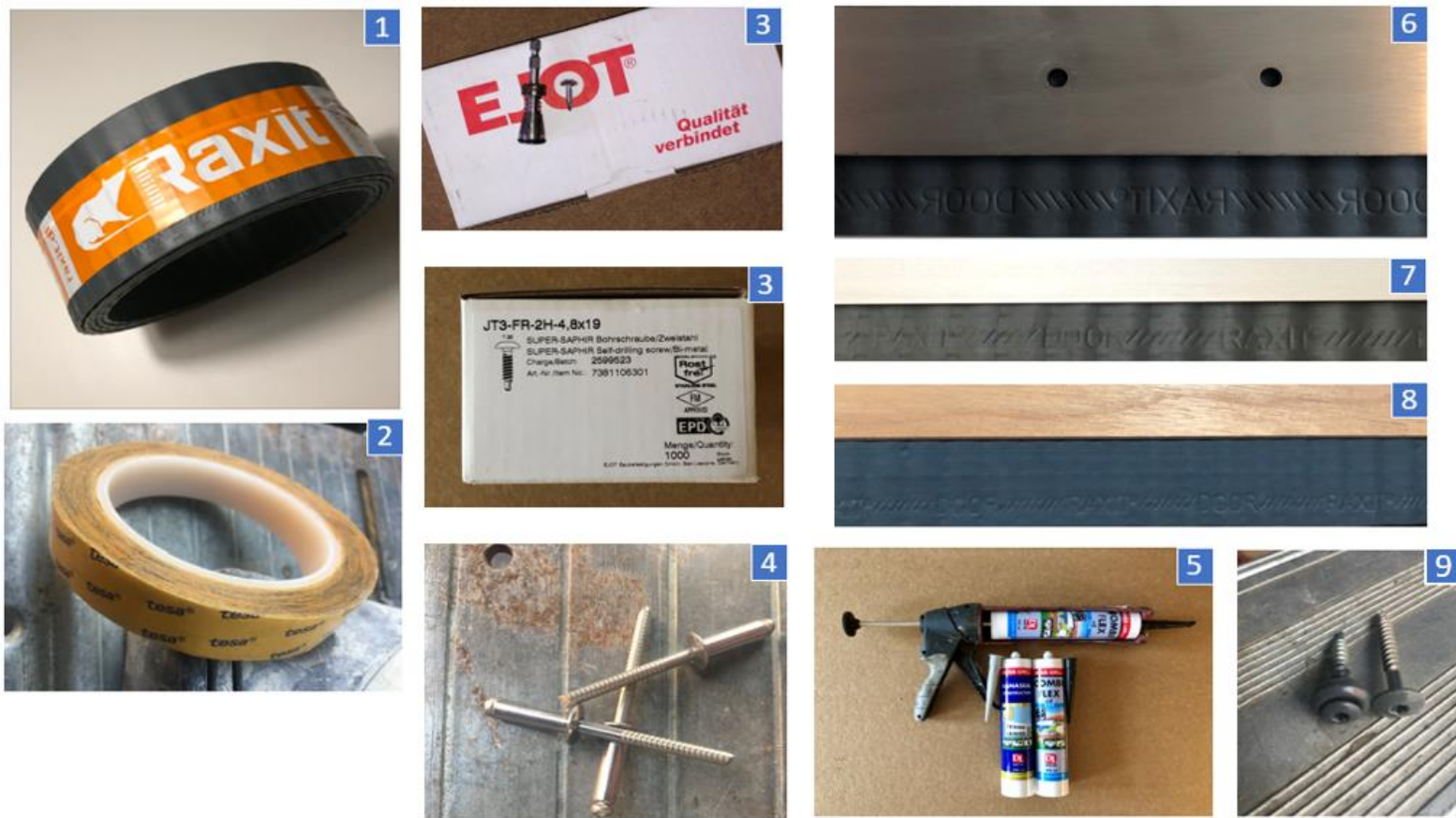

1. Raxit Door Seal (1, 3, 12, 25 meters)
2. Double-sided tape
3. Stainless Steel Screws – we recommend EJOT JT3-FR-2H-4,8x19, or
4. Stainless Steel Pop Rivets 4,8 mm
5. Building sealants and adhesive sealants

Four Choices of horizontal Protection Strips and vertical Shielding Strips

6. Stainless Steel Protection Strip/Shielding Strip (industrial mounting)
 - We recommend using a Stainless-Steel Protection Strip for doors that are subject to heavy load and collisions, from e.g. pallet jacks
7. Aluminum Protection Strip/Shielding Strip
 - We recommend using an Aluminum Protection Strip for doors that are subject to moderate load.
8. Wooden Protection Strip/Shielding Strip
 - We recommend using a Wooden Protection Strip for wooden doors to maintain the doors look.
9. Flat-headed screw
 - We recommend using a flat-headed screw for doors that are subject to minimal load, this is the fastest and easiest mounting method.

Tools



1. Screw Driver
2. 5.5 mm drill
3. Snipping Tool
4. Knife
5. Saw
6. Grinder

Raxit Door Seal Exterior Double Door



10 minutes

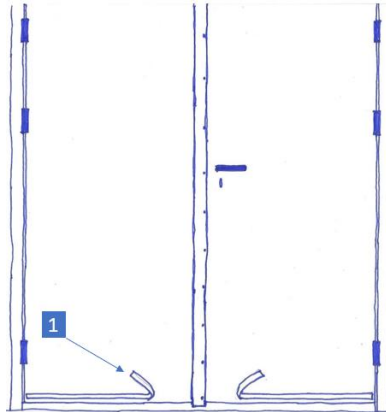

1. Clean the lower section of both doors to ensure the double-sided tape will stick.

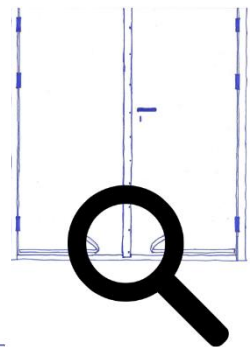
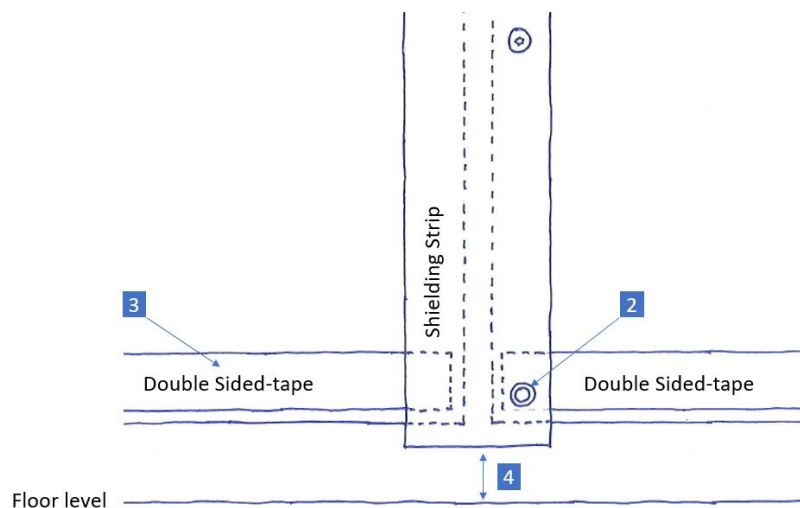

2. Remove the bottom screw from the Shielding Strip.
3. Place double-sided tape on both doors, make sure the double-sided tape is placed underneath the loosened Shielding Strip.
4. The gap between Shielding Strip and floor level should be maximum 20 mm.

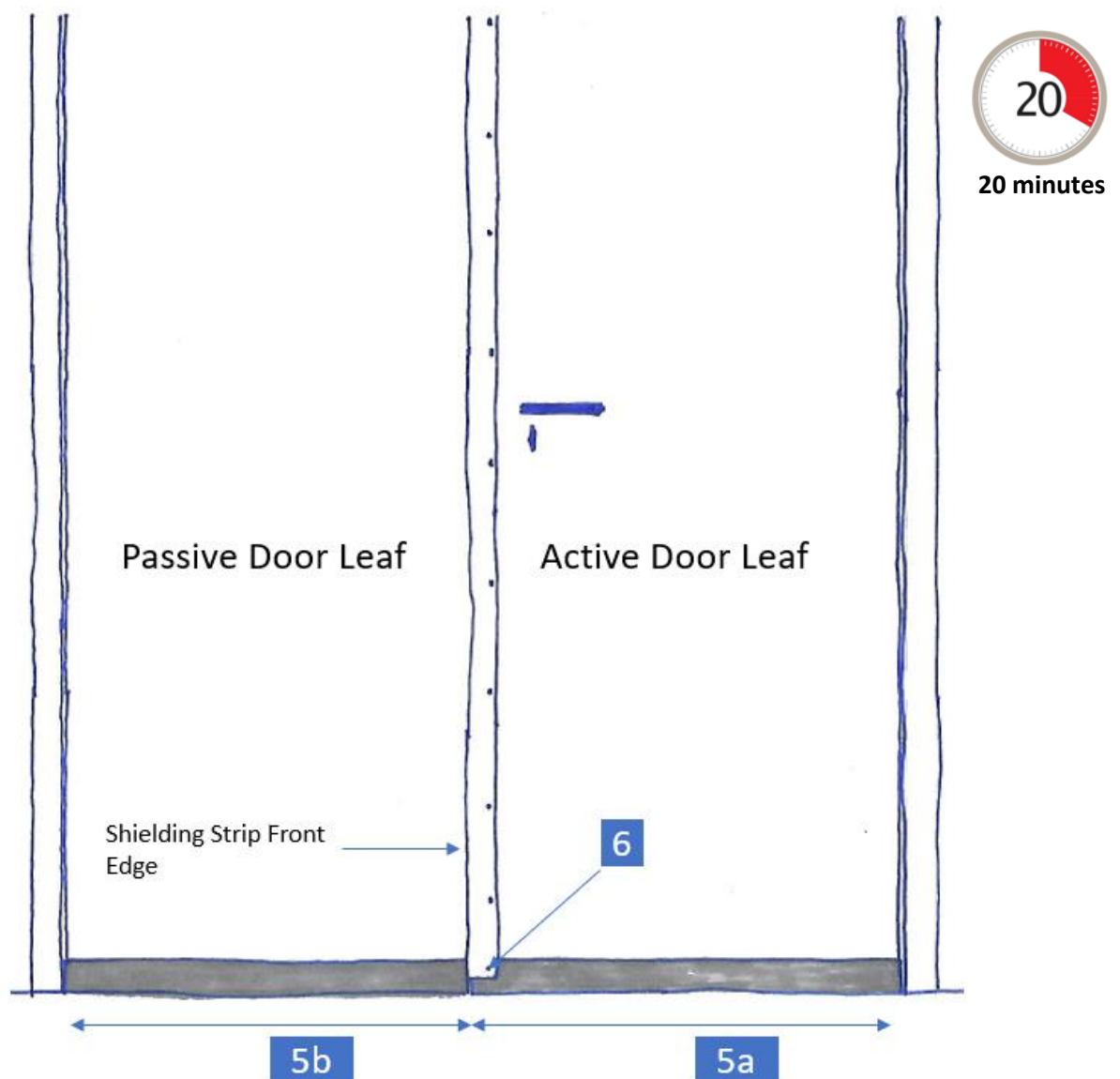

5. Prior to applying the Raxit Seal on the double-sided tape, it is important to adjust the Raxit Seals correctly according to the door's measurements.
 - a. On the active door leaf measurement "5a" is taken 2mm from the door post to the front edge of the Shielding Strip. This means the Raxit Door Seal must be fitted underneath the loosened Shielding Strip on top of the double-sided tape.
 - b. On the passive door leaf measurement "5b" is taken 2mm from the door post to the front edge of the Shielding Strip. Thereafter apply the Raxit Door Seal on top of the double-sided tape.
 - c. The gap between the two Raxit Seals must not exceed 2 mm (see illustration on page 5).
6. The bottom screw on the Shielding Strip is tightened and screwed through the Raxit Seal (see closer illustration on page 5).

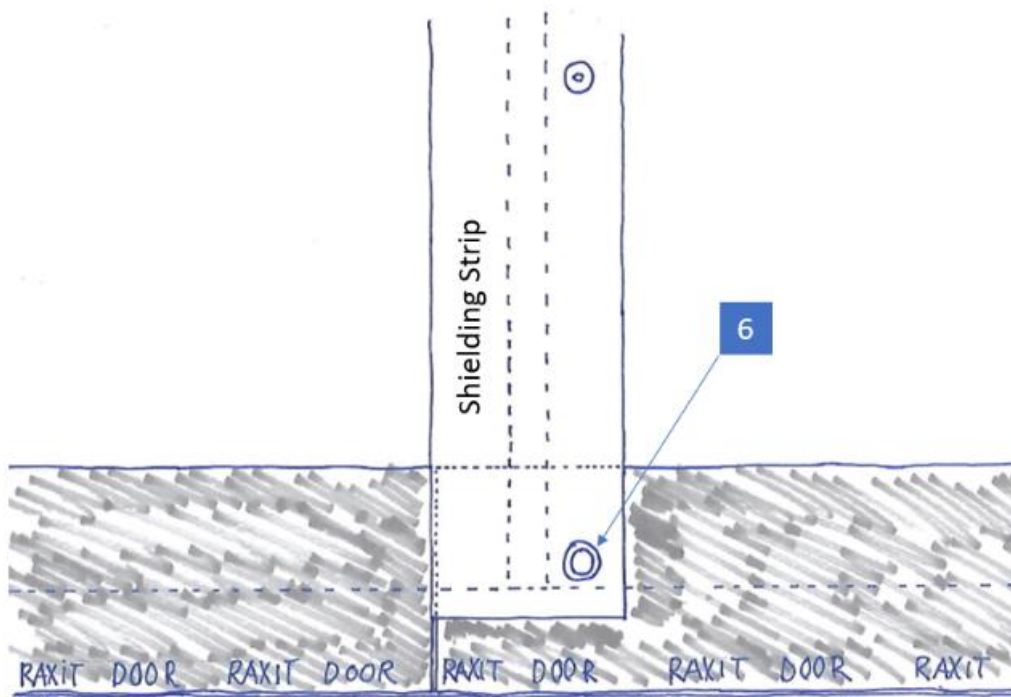

5c The gap between the two Raxit Seals must not exceed 2 mm

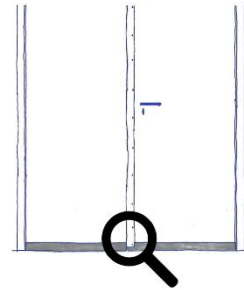



**35 minutes total spent
for an experienced
fitter**

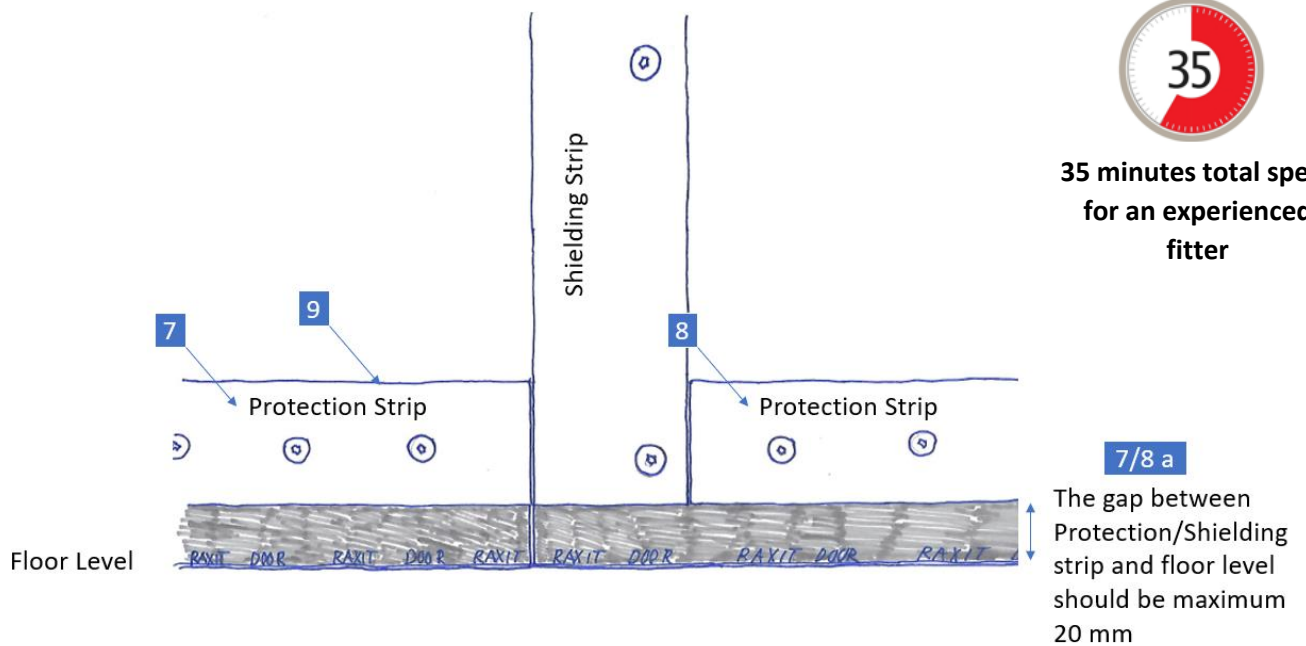

7. The horizontal Protection Strip on the passive door is applied. Measure 2 mm from the door post to the vertical Shielding Strip, cut the Protection Strip according to this measurement and attach the Protection Strip with screws.
 - a. The gap between Protection/Shielding Strip and floor level should be maximum 20 mm
8. The horizontal Protection Strip on the active door is applied. Measure 2mm from the door post to 2mm from the vertical Shielding Strip, cut the Protection Strip according to this measurement and attach the protection Strip with screws.
 - a. The gap between Protection/Shielding Strip and floor level should be maximum 20 mm
9. Apply sealant on top of both horizontal Protection Strips

10. Mounting of the Raxit Seal is complete, and the door is pest-proof.

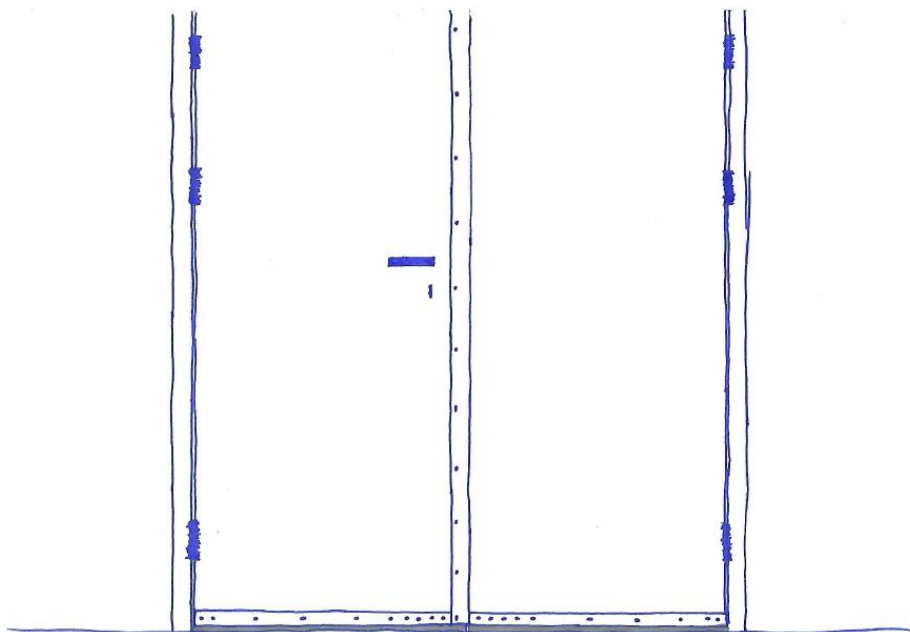

Good to know

As a general note to our customers, we advise you to inspect the Raxit Seals regularly for any damages. From our experience, doors that are subject to heavy loads as in e.g. grocery stores should have its Raxit Door Seals changed every 1 or 1.5 years.

1. Metal & Plastic pieces to ease alignment and mounting

1,5 mm high plastic pieces are placed underneath the Raxit Seal during mounting. This ensures that the seal is well aligned to the floor level and that the door can open and close smoothly. The Raxit Seal should never be more than 2 mm away from the door level.

Metal piece used to align the horizontal protection strip to 20 mm from floor level.



2. The Raxit Door Seal has a top and a bottom. Make sure to place the bottom of the seal against the floor level.

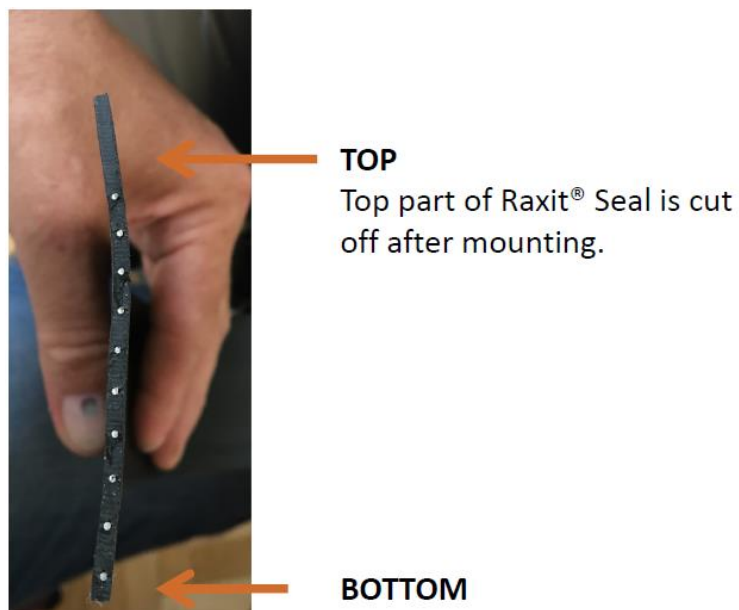

3. The terrain in front of the door should fall:

- a. This will ensure easy and smooth opening and closing of the door
- b. Reduce the tear and wear of the Raxit Seal to increase its longevity

